



ID: 1458

APARTMENT

Berlin, Germany

€ 221,000

Property Details:

Type of Property: Apartment

Property Type: Secondary market

Living Area: 58.85 m²

Land Area: 1055 m²

Total Area: 58.85 m²

Bathrooms: 1

Layout:

Near metro / stop

Near the shop

Apartment house

Financial Information:

Installment

Mortgage

Purchase Cost:

Agency commission:
7.14%

Tax on the purchase:
6%

Services notary:
1%

Inventory:
0.5%

Rental services

Services of the
management company

You will love this charming 2-bedroom apartments in Berlin, Mitte borough. The property is located in KAA-6 residential complex.

Total Area – 58.85 m²

Price – €221,000

Year built - 1905

The maintenance and modernization of the building is being made on a regular basis since 1990. The latest construction technologies, and exclusive building materials of the leading German brands was used during an overhaul of the whole house.

The apartment is located on the 2nd floor of a 5-storey building. It has 2 rooms (21.41 m² and 8.35 m²), a spacious kitchen (12.58 m²) and 2 bathrooms and a hallway. The apartment is in excellent condition.

The property is located in the Moabit area near the city center. All the necessary locations such as supermarkets, pharmacies, restaurants and banks are within walking distance. The residential building is located right near the Spree River. U-Bhf and S-Bhf Metro Stations are a 10-minute away walking.

If you are interested in other properties, you can leave a request on our web site. Our representative will contact you shortly to assist you and answer the questions you might have.

Do not miss a unique opportunity to have 2-bedroom apartment in Berlin!



EW Immobilien Real Estate GmbH
Amtsgericht Charlottenburg HRB 199840 B
Geschäftsführung: Igor Siebert
USt-IdNr.: DE319993277
Bank: Berliner Volksbank
IBAN: DE53 1009 0000 2742 4050 04
BIC: BEVODEBB

Kufürstendamm 45
10719 Berlin
Tel: +49 (0) 30 886 281 04
Fax: +49 (0) 322 255 548 25
E-Mail: info@ew-realestate.com
Web: www.ew-realestate.com



Wfl.-Wohnung 27-1-SF-1-LOG-li

Zimmer 1 ca.	21,41 m ²
Zimmer 2 ca.	8,35 m ²
Küche ca.	12,58 m ²
Flur ca.	8,26 m ²
Bad ca.	2,47 m ²
Abst. ca.	5,78 m ²
Summe	58,85 m ²
WE 27 ca.	

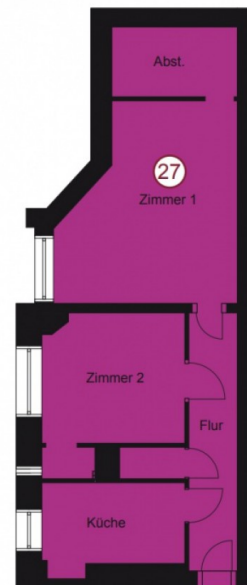



EW REAL ESTATE

EW Immobilien Real Estate GmbH
Amtsgericht Charlottenburg HRB 199840 B

Geschäftsführung: Igor Siebert

USt-IdNr.: DE319993277

Bank: Berliner Volksbank

IBAN: DE53 1009 0000 2742 4050 04

BIC: BEVODEBB

Kufürstendamm 45
10719 Berlin

Tel: +49 (0) 30 886 281 04

Fax: +49 (0) 322 255 548 25

E-Mail: info@ew-realestate.com

Web: www.ew-realestate.com